

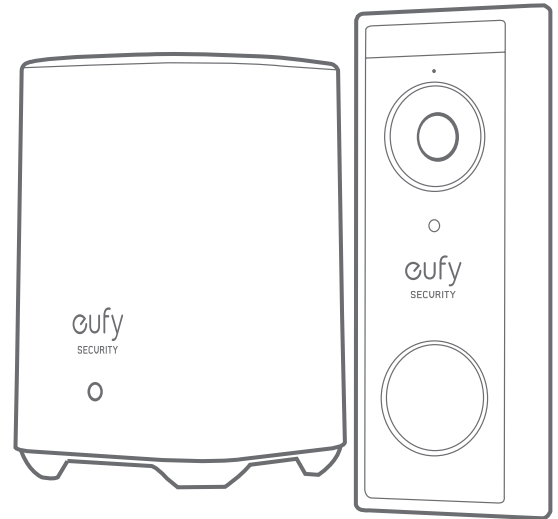

QUICK START GUIDE

Video Doorbell 2K (Battery-Powered)



Anker Innovations Limited. All rights reserved. eufy Security and eufy Security Logo are trademarks of Anker Innovations Limited, registered in the United States and other countries. All other trademarks are the property of their respective owners.

51005001867 V02

TABLE OF CONTENTS

What's Included	02	13	Mounting The Bracket
Product Overview	04	16	Mounting The Doorbell
How The System Works	06	17	Detaching The Doorbell
Connecting The Homebase	07	18	Recharging The Doorbell
Setting Up The System	08	19	Powering The Doorbell With Existing Doorbell Wires
Determining The Power Option	09	27	Notice
Finding A Mounting Spot	11	30	Customer Service

WHAT'S INCLUDED

For Video Doorbell Installation



Video Doorbell 2K
(Battery-Powered)
Model:T8210

FCC ID: 2AOKB-T8210
IC: 23451-T8210

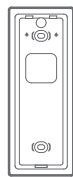

Mounting Bracket



Screw Hole Positioning
Card



15° Mounting Wedge
(Optional)

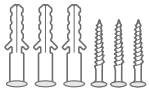

Screw Packs (Spare
screws and anchors are
included)

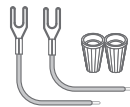

Extension Wires and
Wire Nuts (Optional)



USB Charging
Cable



Doorbell Detaching
Pin



Quick Start Guide

For HomeBase 2 Installation



HomeBase 2
Model:T8010X

FCC ID: 2AOKB-T8010X
IC: 23451-T8010X

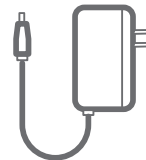

Power Adapter for
HomeBase 2

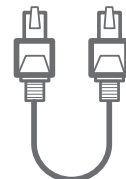

Ethernet Cable for
HomeBase 2

Note: Power plug may vary in different regions.

PRODUCT OVERVIEW

Video Doorbell (Battery Powered)

Front view:

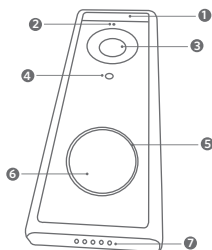

1. Motion Sensor
2. Microphone
3. Camera Lens
4. Ambient Light Sensor
5. LED Ring
6. Doorbell Button
7. Speaker

Rear View:

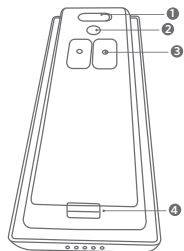

1. Micro USB Charging Port
2. SYNC/RESET Button
3. Power Terminals for Existing Doorbell Wire (Optional)
4. Detaching Mechanism

Video Doorbell (Battery Powered)

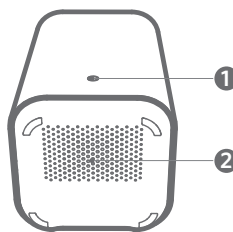

1. Status LED
2. Speaker
3. Power port
4. USB port

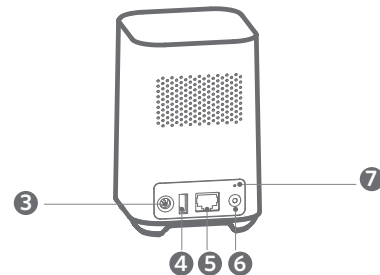

5. Ethernet port
6. SYNC/ALARM OFF button
7. Reset button

Operation	How-to
Power on	Press and release the SYNC button
Add doorbell to HomeBase	Press and hold the SYNC button until you hear a beep
Power off the doorbell	Quick-press the SYNC button 5 times in 3 seconds.
Reset the doorbell	Press and hold the SYNC button for 10 seconds.

HOW THE SYSTEM WORKS

How the System Works

The video doorbell system includes 2 parts. One is the video doorbell at your door. The other is the HomeBase in your house.

The video doorbell detects motion at your porch and allows you to answer the door anytime and anywhere. The HomeBase stores video clips on its built-in storage. When someone rings the doorbell, people in the house will be notified.

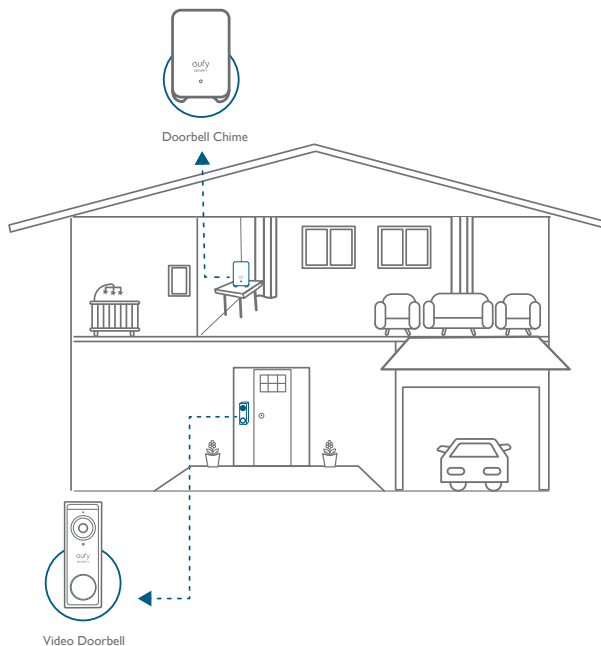

STEP 1 CONNECTING THE HOMEBASE

Connect the HomeBase 2 to the Internet

1. Power on the HomeBase 2, then use the ethernet cable provided to connect the HomeBase 2 to your home router.

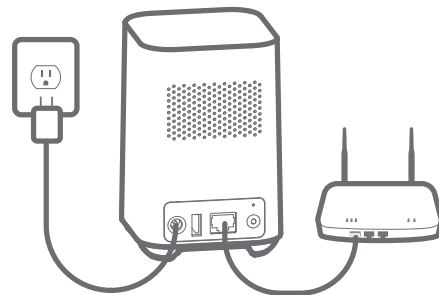

2. The LED indicator turns blue (this may take up to 1 min) when HomeBase 2 is ready for setup.

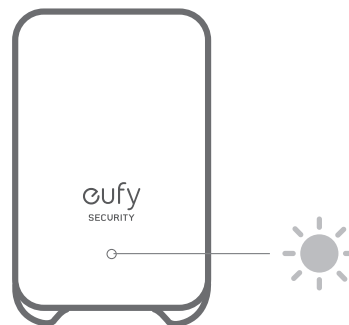

STEP 2 SETTING UP THE SYSTEM

Download the App and Set up the System

Download the Eufy Security app from the App Store (iOS devices) or Google Play (Android devices).



Sign up for a Eufy Security account, then follow the onscreen instructions to complete the setup.

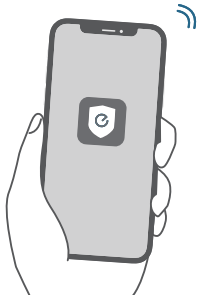

STEP 3 DETERMINING THE POWER OPTION

Option 1 - Battery Powered

1. If you don't have existing doorbell wiring at the front door, use the built-in battery. You are free to determine the doorbell position and the mounting is easy and quick.
2. When the doorbell battery level is low, you need to detach and charge it.
3. If you choose this option, please jump to **STEP 4 FINDING A MOUNTING SPOT**.

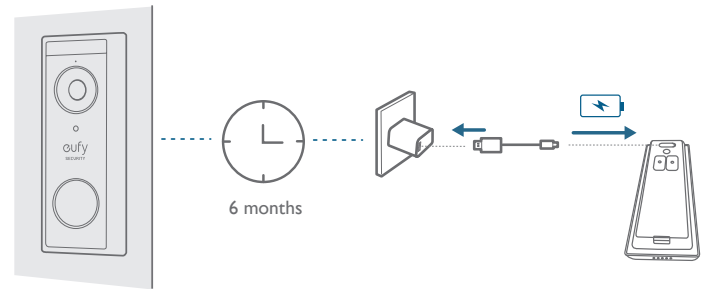

Note: The battery life varies depending on usage. In most common cases, a doorbell may have up to 10 events per day and each recording lasts 20 seconds on average. Under this scenario, the doorbell battery life can last up to 6 months.

Option 2 - Doorbell Wire Powered

1. If you have existing and working doorbell wiring at the front door, the doorbell will be powered by the wires constantly. So you don't need to detach and charge it after installation.
2. Since the doorbell is connected to the wires, the mounting position is limited.
3. If you choose this option, please jump to **Appendix 3 Powering the Doorbell with Doorbell Wires**.

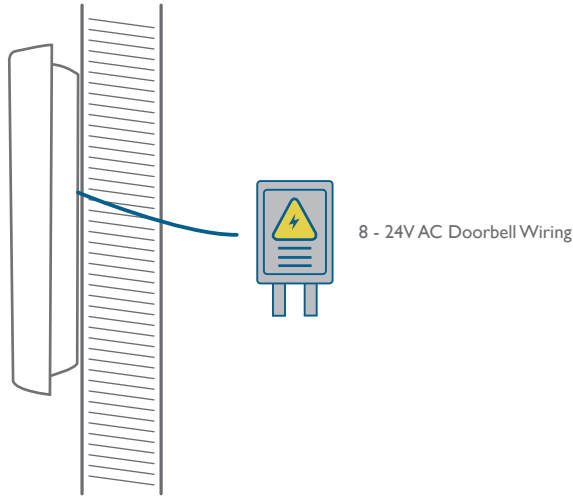

STEP 4 FINDING A MOUNTING SPOT

Find a Mounting Spot

Take the video doorbell to your front door and check the live view on the App at the same time. Find a location where you can get the desired field of view.

Consider the below factors:

1. Check if you can reuse the existing holes and anchors on the wall or door frame.
2. If you want to place the doorbell close to a side wall, make sure the wall doesn't show up in the field of view. Otherwise IR light will be reflected and night vision will become blurry.
3. If you are drilling the mounting holes for the first time, the recommended mounting height is 48" / 1.2 m from the ground.
4. Use the 15° mounting wedge as a supplementary mounting bracket if you wish to see more on a specific side.

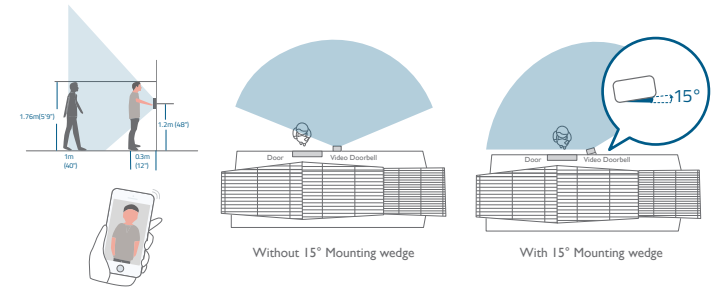

Place the Screw Hole Positioning Card against the wall to mark the position.

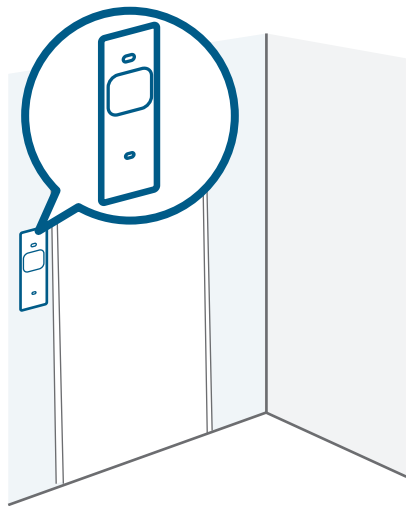

STEP 5 MOUNTING THE BRACKET

Mount the Doorbell on a Wooden Surface

If you're mounting the doorbell on a wooden surface, you don't need to pre-drill pilot holes. Use the provided screws to secure the Mounting Bracket on the wall. The Screw Hole Positioning Card indicates the position of the screw holes.

What is required: Screwdriver, Mounting Bracket, 15° Mounting Wedge (Optional), Screw Packs

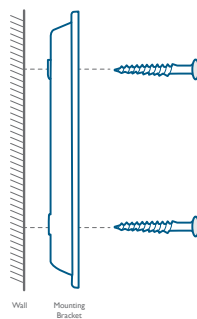
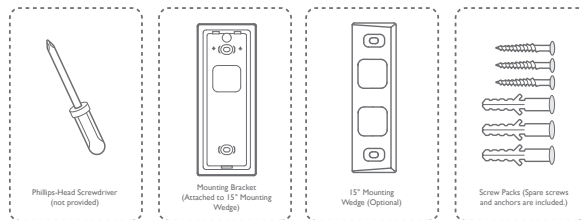

Without 15° Mounting Wedge

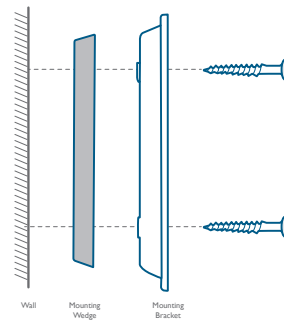

With 15° Mounting Wedge

Mount the Doorbell on Surfaces Made Out of Hard Materials

1. If you're mounting the doorbell on a surface made out of hard materials, like brick, concrete, stucco, drill 2 holes through the Screw Hole Positioning Card with a 15/64"(6mm) drill bit.
2. Insert the provided anchors, and then use the provided long screws to secure the Mounting Bracket on the wall.

What is required: Power Drill, 15/64"(6 mm) Drill Bit, Mounting Bracket, 15° Mounting Wedge (Optional), Screw Packs

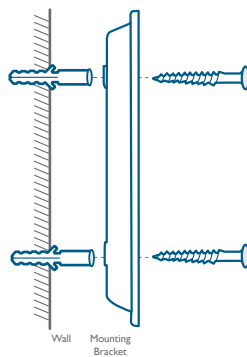
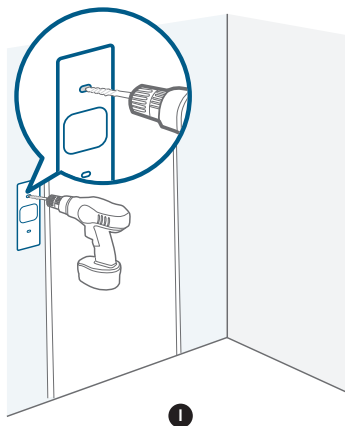
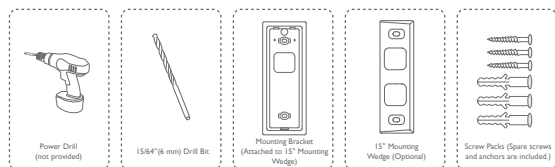

Without 15° Mounting Wedge

2

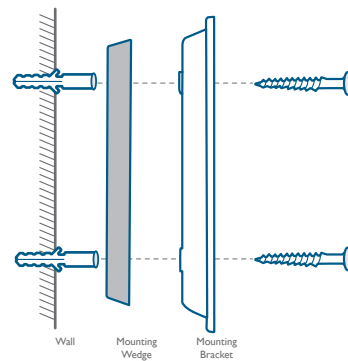

With 15° Mounting Wedge

2

STEP 6 MOUNTING THE DOORBELL

Mount the Doorbell

Align the doorbell on top and then snap it on the bottom. Press it down until it clicks into place.

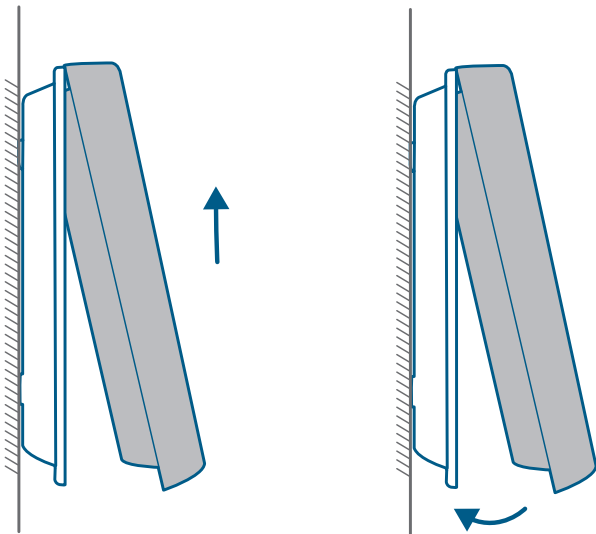

You're all set!

If you want to detach the doorbell or recharge it, please refer to the following sections.

APPENDIX I DETACHING THE DOORBELL

Detach the Doorbell

1. Use the doorbell detaching pin provided if you wish to detach the doorbell from the Mounting Bracket.
2. Press and hold the hole on the bottom of the doorbell and then lift its bottom to take it off.

What is required: Doorbell Detaching Pin

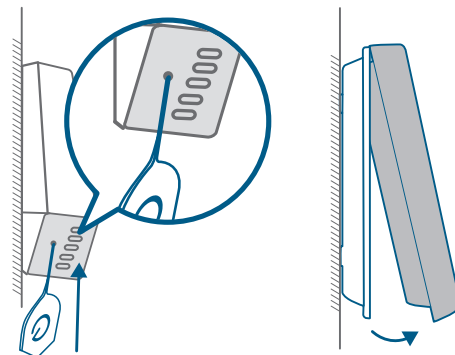
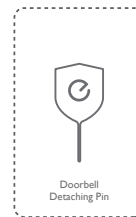

APPENDIX 2 RECHARGING THE DOORBELL

Recharge the Doorbell

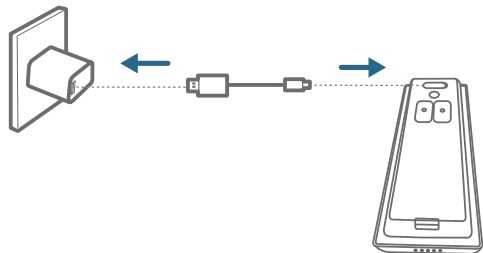
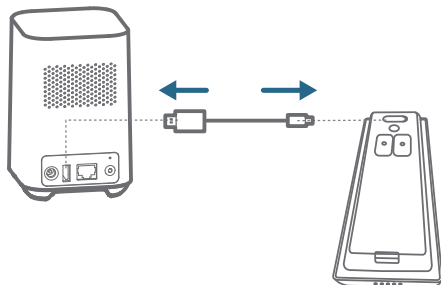

LED indication	Charging: Solid orange
	Fully charged: Solid cyan
Charging time	6 hours from 0% to 100%

APPENDIX 3 POWERING THE DOORBELL WITH EXISTING DOORBELL WIRES

3.1 Verify whether the doorbell wires are working

1. Ring the existing doorbell to check if it is working. If the doorbell doesn't ring, your doorbell wires may be defective. Power the doorbell on its own battery or consult an electrician to fix the wires.
2. Shut off power at the breaker. Turn the lights on / off in your home to make sure the electricity in your house is properly shut off.

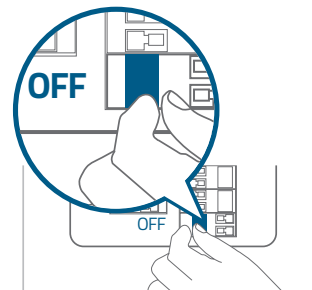

Always be careful when handling wires. If you're not comfortable installing it yourself, have a qualified electrician do it.

3.2 Detach the Existing Doorbell Button

If you already have existing doorbell wiring:

1. Remove the existing doorbell button with a Phillips-Head screwdriver (not provided).
2. Pull the two wires out carefully when removing the existing doorbell. Straighten the wire ends if necessary.

What is required: Philips-Head Screwdriver

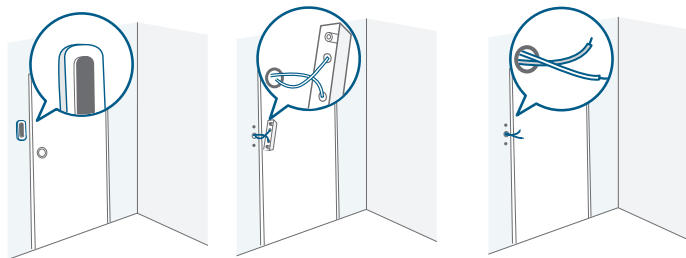
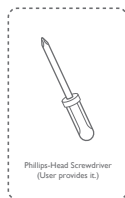

3.3 Find a Mounting Spot

- I. Determine the mounting position of the doorbell. Consider the below factors:
 - ① Check if you can reuse the existing holes and anchors on the wall or door frame.
 - ② If you are drilling the mounting holes for the first time, the recommended mounting height is 48" / 1.2 m from the ground.
 - ③ Use the 15° mounting wedge as a supplementary mounting bracket if you wish to see more on a specific side.

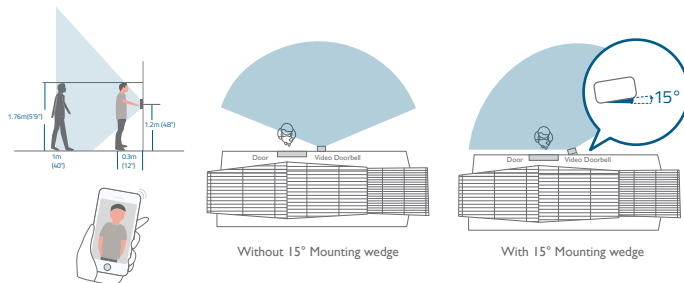

2. Place the Screw Hole Positioning Card against the wall to mark the position.

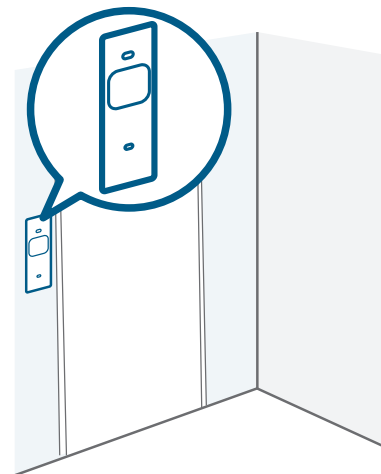

3.4 Mount the Bracket

If you're mounting the doorbell on a wooden surface, you don't need to pre-drill pilot holes. Use the provided screws to secure the Mounting Bracket on the wall. The Screw Hole Positioning Card indicates the position of the screw holes.

What is required: Power Drill, Mounting Bracket, 15° Mounting Wedge (Optional), Screw Packs

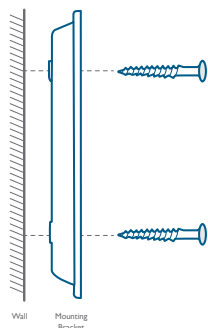
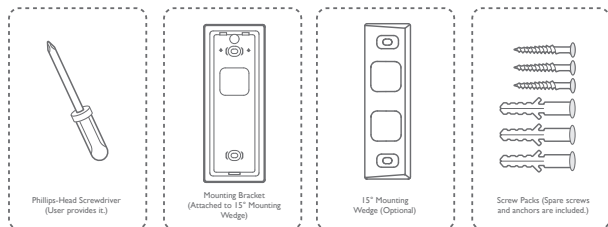

Without 15° Mounting Wedge

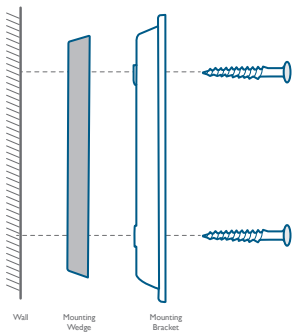

With 15° Mounting Wedge

If you're mounting the doorbell on a surface made out of hard materials, like brick, concrete, stucco:

- ① Drill 2 holes through the Screw Hole Positioning Card with 15/64"(6mm) drill bit.
- ② Insert the provided anchors, and then use the provided long screws to secure the Mounting Bracket on the wall.

What is required: Power Drill, 15/64"(6mm) Drill Bit, Mounting Bracket, 15° Mounting Wedge (Optional), Screw Packs

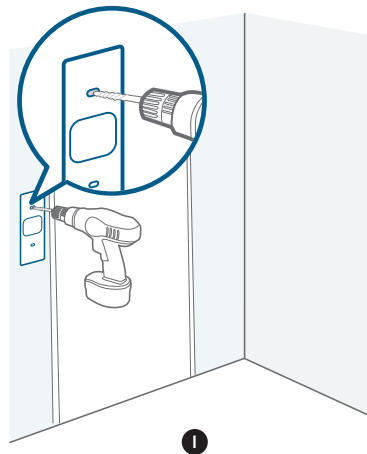
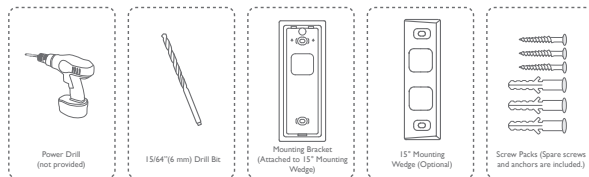

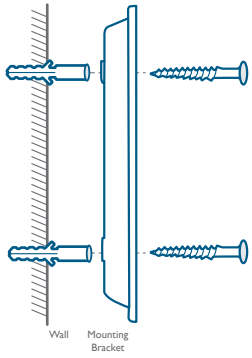

Wall
Mounting
Bracket

Without 15° Mounting Wedge

2

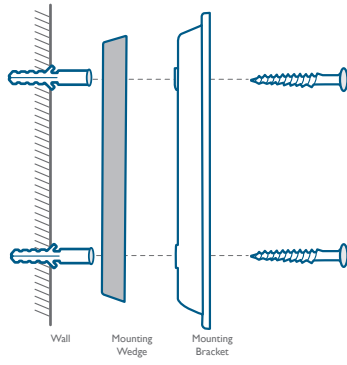

Wall
Mounting
Wedge
Mounting
Bracket

With 15° Mounting Wedge

2

3.5 Connect the Doorbell Wires to the Doorbell

Connect the wires to the terminals at the back of the doorbell, then tighten the terminal screws. Wire can connect to any terminal.

What is required: Wires and Wire Nuts (Optional), Video Doorbell, Philips-head Screwdriver

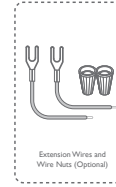

Extension Wires and
Wire Nuts (Optional)

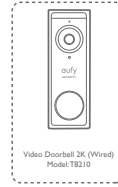

Video Doorbell 2K (Wired)
Model:TB210

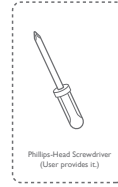

Philips-Head Screwdriver
(User provides it.)

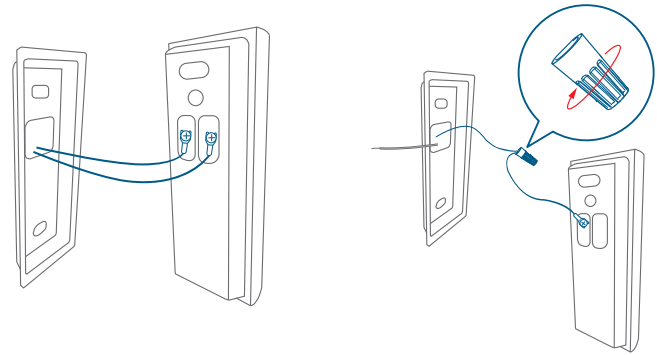

Note:

- To prevent short-circuit, make sure the wires are not touching each other after connecting them to the terminals.
- If the wires are too short, use the extension wires and wire nuts provided to make them longer. Use electrical wiring tape instead if there is no more space on the wall for wire nuts.

3.6 Mount the Doorbell on the Bracket

Align the doorbell on top and then snap it on the bottom.

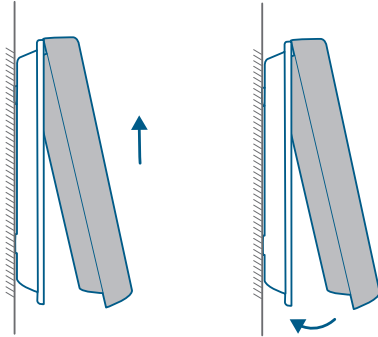

3.7 Restore Power

Switch the master circuit breaker back to ON.

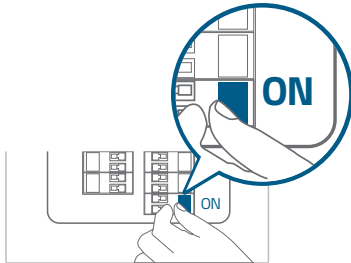

You're all set!

If you want to detach the doorbell or recharge it, please refer to the corresponding sections.

NOTICE

FCC Statement

This device complies with Part 15 of the FCC Rules. Operation is subject to the following two conditions: (1) this device may not cause harmful interference, and (2) this device must accept any interference received, including interference that may cause undesired operation.

Warning: Changes or modifications not expressly approved by the party responsible for compliance could void the user's authority to operate the equipment.

Note: This equipment has been tested and found to comply with the limits for a Class B digital device, pursuant to Part 15 of the FCC Rules. These limits are designed to provide reasonable protection against harmful interference in a residential installation.

This equipment generates uses and can radiate radio frequency energy and, if not installed and used in accordance with the instructions, may cause harmful interference to radio communications. However, there is no guarantee that interference will not occur in a particular installation. If this equipment does cause harmful interference to radio or television reception, which can be determined by turning the equipment off and on, the user is encouraged to try to correct the interference by one or more of the following measures: (1) Reorient or relocate the receiving antenna. (2) Increase the separation between the equipment and receiver. (3) Connect the equipment into an outlet on a circuit different from that to which the receiver is connected. (4) Consult the dealer or an experienced radio/TV technician for help.

FCC Radio Frequency Exposure Statement

The device has been evaluated to meet general RF exposure requirements. The device can be used in fixed/mobile exposure condition. The min separation distance is 20cm.

Notice: Shielded cables

All connections to other computing devices must be made using shielded cables to maintain compliance with FCC regulations.

The following importer is the responsible party:

Company Name: POWER MOBILE LIFE, LLC

Address: 400 108th Ave NE Ste 400, Bellevue, WA 98004-5541

Telephone: 1-206-383-8247

 This product complies with the radio interference requirements of the European Community.

Declaration of Conformity

Hereby, Anker Innovations Limited declares that this device is in compliance with the essential requirements and other relevant provisions of Directive 2014/53/EU. For the declaration of conformity, visit the Web site: <https://www.eufylife.com/>.

This product can be used across EU member states.

Do not use the Device in the environment at too high or too low temperature, never expose the Device under strong sunshine or too wet environment.

The suitable temperature for HomeBase 2 and accessories is -10°C-45°C.

The suitable temperature for Video Doorbell 2K (Wired) and accessories is -20°C - 50°C .

When charging, please place the device in an environment that has a normal room temperature and good ventilation.

It is recommended to charge the device in an environment with a temperature that ranges from 5°C~25°C.

RF exposure information: The Maximum Permissible Exposure (MPE) level has been calculated based on a distance of d=20 cm between the device and the human body. To maintain compliance with RF exposure requirement, use product that maintain a 20cm distance between the device and human body.

CAUTION RISK OF EXPLOSION IF BATTERY IS REPLACED BY AN INCORRECT TYPE. DISPOSE OF USED BATTERIES ACCORDING TO THE INSTRUCTIONS

For HomeBase 2: Wi-Fi Operating Frequency Range: 2412~2472MHz ; Wifi Max Output Power: 17.13dBm(EIRP)

SUB-1G Frequency range: 866~866.8MHz; SUB-1G Output Power: 5.492dBm(EIRP)

For Video Doorbell 2K (Wired) :

Wi-Fi Operating Frequency Range: 2412~2472MHz ; Wi-Fi Max Output Power: 18.30 dBm

SUB-1G Frequency range: 433.92 MHz; SUB-1G Output Power: 7.407 dBm

Bluetooth Operating Frequency Range: 2402~2480MHz; Bluetooth Max Output Power: 0.77 dBm

The following importer is the responsible party (contact for EU matters only)

Importer: Anker Technology (UK) Ltd

Importer Address: Suite B, Fairgate House, 205 Kings Road, Tyseley, Birmingham, B11 2AA, United Kingdom



This product is designed and manufactured with high quality materials and components, which can be recycled and reused.



This symbol means the product must not be discarded as household waste, and should be delivered to an appropriate collection facility for recycling. Proper disposal and recycling helps protect natural resources, human health and the environment. For more information on disposal and recycling of this product, contact your local municipality, disposal service, or the shop where you bought this product.

IC Statement

This device complies with Industry Canada licence-exempt RSS standard(s). Operation is subject to the following two conditions:

- (1) this device may not cause interference, and
- (2) this device must accept any interference, including interference that may cause undesired operation of the device."

Le présent appareil est conforme aux CNR d'Industrie Canada applicables aux appareils radio exempts de licence. L'exploitation est autorisée aux deux conditions suivantes:

- (1) l'appareil ne doit pas produire de brouillage, et
- (2) l'utilisateur de l'appareil doit accepter tout brouillage radioélectrique subi, même si le brouillage est susceptible d'en compromettre le fonctionnement."

This Class B digital apparatus complies with Canadian ICES-003.

Cet appareil numérique de la classe B est conforme à la norme NMB-003 du Canada.

IC RF Statement:

When using the product, maintain a distance of 20cm from the body to ensure compliance with RF exposure requirements.

Lors de l'utilisation du produit, maintenez une distance de 20 cm du corps afin de vous conformer aux exigences en matière d'exposition RF.

CUSTOMER SERVICE

- **Warranty**

12-month limited warranty

- **Call Us**

United States +1 (800) 988 7973 Mon-Fri 9AM-5PM (PT)

United Kingdom +44 (0) 1604 936 200 Mon-Fri 6AM-11AM (GMT)

Germany +49 (0) 69 9579 7960 Mo-Fr 6:00-11:00

- **Email Us**

Customer Support: support@eufylife.com

Anker Innovations Limited

Room 1318-19, Hollywood Plaza, 610 Nathan Road, Mongkok, Kowloon,
Hong Kong



@EufyOfficial



@EufyOfficial



eufyofficial

